

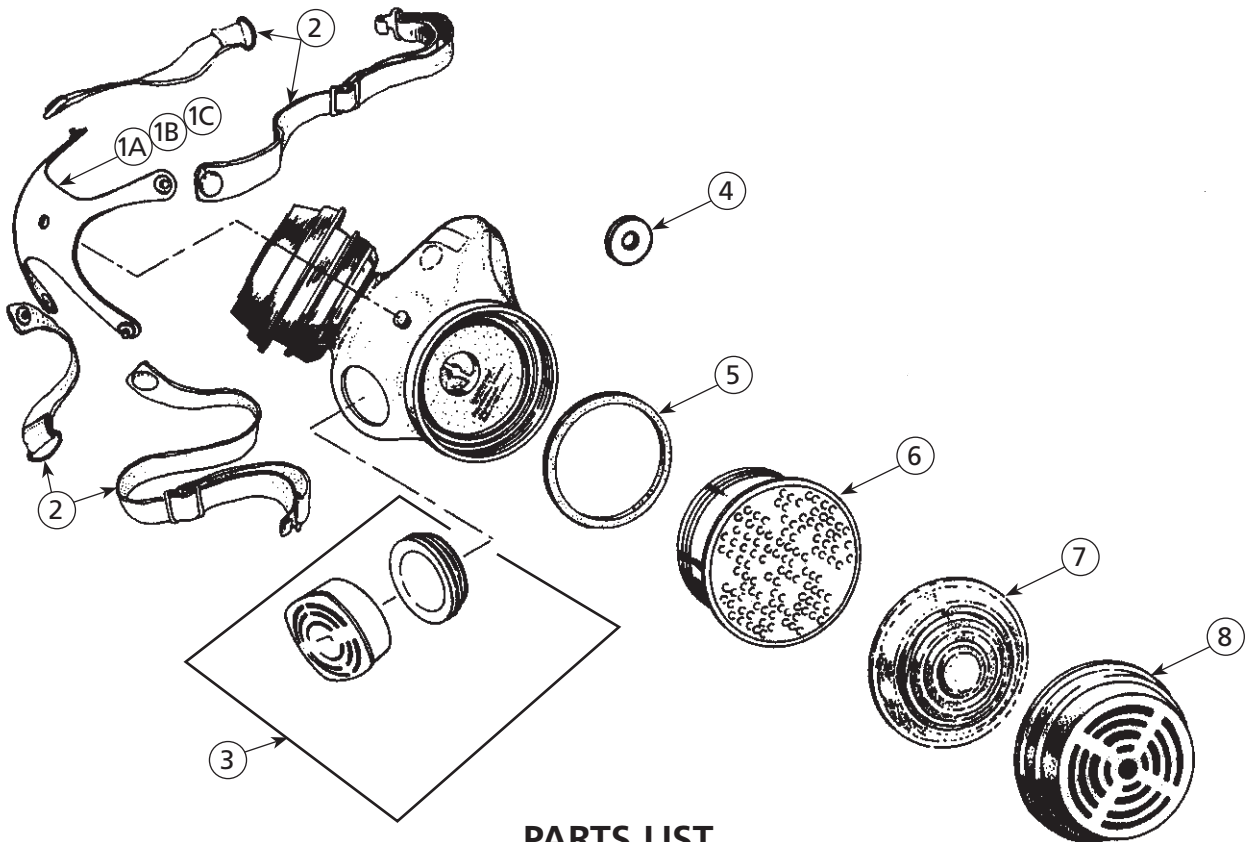

Binks PAINT SPRAY RESPIRATOR

**MODELS 40-128 (MEDIUM),
40-141 (SMALL) & 40-143 (LARGE)**

Model	Size	Application	MSHA-NIOSH Approval Number
40-128	Medium	Organic vapors; paint, lacquer and enamel mists; dusts and mists.	TC23C-87
40-141	Small		
40-143	Large		



PARTS LIST

When ordering, please specify Part No.

ITEM NO.	PART NO.	DESCRIPTION	QTY.	ITEM NO.	PART NO.	DESCRIPTION	QTY.
1A	—	YOKE, 40-128 MEDIUM (ALUMINUM).....	1	5*	—	GASKET	2
1B	—	YOKE, 40-141 SMALL (BLACK)	1	6†	40-1921	CARTRIDGE (2/PK).....	1
1C	—	YOKE, 40-143 LARGE (GOLD).....	1	7‡	40-1924	PRE-FILTER (10/PK).....	1
2*	—	HEADBAND SET	1	8*	40-1925	RETAINER (2/PK).....	1
3*	—	COVER & VALVE ASSEMBLY	1				
4*	—	DIAPHRAGM	2				

* Available in 40-1928 Tune-up Kit; order separately.

† Replacement also available in packages of 10 (40-1921-10).

‡ Replacement also available in packages of 10 (40-1924-10).

BINKS PAINT SPRAY RESPIRATOR – INSTRUCTIONS FOR USE

- The enclosed twin chemical cartridges, for protection against organic vapors, must be installed in this respirator before use. To install cartridges, proceed as follows:
 - Remove the snap-type filter covers (containing the filters) from the respirator.
 - Remove the chemical cartridges from storage bags and insert into the threaded receptacles, making sure gaskets are in place in the cartridge holders. Hand tighten the cartridges with CAUTION to prevent damage to threads and to insure a good seal against the gaskets.
 - Replace filters and filter covers with CAUTION so as to prevent damage to the filters.
- Fit respirator on nose bridge, making sure that you are able to breathe through nose, then swing bottom of respirator into contact with the chin. Position headbands with longest headband above the ears and the shortest headband below the ears. Tighten or loosen straps by moving slides either way.
- Test respirator for leakage, using a positive pressure method to test the fit, lightly cover the exhalation valve with the palm of your hand. Exhale... if there is a leak, you will feel the air on your face. If leakage occurs around face cushion, readjust facepiece and yoke and retest.
- When odors of vapors or gases become noticeable, it is a sign that the chemical cartridges have served their useful life and should be replaced. To replace cartridges, proceed as follows:
 - Remove the expended chemical cartridges and discard.
 - Remove the replacement chemical cartridges from storage bags and insert into the threaded receptacles making sure gaskets are in place in the cartridge holders.
 - Hand tighten the cartridges with CAUTION to prevent damage to threads and to insure a good seat against the gaskets.
- When resistance to breathing becomes noticeable, it is a sign that the filters have served their useful life and should be replaced. To replace filters, proceed as follows:
 - Remove the snap type filter covers and discard filters.
 - Insert a new filter into each filter cover.
 - Replace filter covers with CAUTION so as to prevent damage to the filters.
- Clean and sanitize respirator after each wearing. A disinfectant type wipe is recommended for cleaning respirator.

⚠ CAUTION

Never subject the respirator to temperatures exceeding 120 degrees F. Distortion of respirator parts can occur with higher temperatures.

NOTE

Store respirator in its carton in a cool dry place.

YOU CAN HELP THE BINKS PAINT SPRAY RESPIRATOR PROTECT YOUR RESPIRATORY SYSTEM

Before Each Use:

- Inspect the respirator
- Change the cartridges and filters if necessary
- Check the fit on your face

After Each Use:

- Clean and Sanitize the respirator
- Replace the used cartridges and filters if necessary

⚠ WARNING

- This device does NOT supply oxygen.
- Use only in adequately ventilated areas containing at least 19.5 percent oxygen.
- Do not use when concentrations of contaminants are unknown, or immediately dangerous to life or health.
- Do not use for urethane paints or other paints containing isocyanates because of their poor warning properties. Use a DeVilbiss Air-Supplied Respirator.
- Leave area immediately if:
 - a. breathing becomes difficult.
 - b. dizziness or other distress occurs.
 - c. you taste or smell contaminant.
- Use strictly in accordance with instructions, labels, and limitations pertaining to this device.
- This device may not provide satisfactory face seal with certain physical characteristics (such as beards, or gross sideburns), as outlined in ANSI Z88.2 1980, resulting in leakage in connection with the facepiece which voids or limits the protection. If such a condition exists, the user assumes all risks of death or serious bodily injury which may possibly result.
- Never alter or modify this device.

FOR USE BY TRAINED QUALIFIED PERSONNEL ONLY

WARRANTY

This product is covered by Binks' 1 Year Limited Warranty.

Binks Worldwide Sales and Service Listing: www.binks.com



North American Office
ITW Industrial Finishing
195 Internationale Blvd.
Glendale Heights, IL 60139
630-237-5000
www.binks.com

Toll Free Customer Service
and Technical Support
800-992-4657
Toll Free Fax
888-246-5732

77-2131R-5 Revisions: Updated graphic standards; (P1) Updated Parts List; (P2) Updated Caution and Warning text.